

**HAY**

# HAY Ava Cone Pendant

LA11324/P

SOURCE: <https://www.davidvillagelighting.co.uk/product/HAY-Ava-Cone-Pendant/10002511>



## PRODUCT DESCRIPTION

**Designer:** Ana Kraš

## HAY Ava Cone Pendant

The HAY Ava Cone Pendant Light distils the empire shade into a crisp, modern pendant form. Constructed from ECOPET™, a recycled polyester derived from post-consumer waste such as bottles and textiles, the conical shade is lightweight, durable, and semi-translucent. Its soft diffusion provides a comfortable ambient pool, perfect for dining tables, kitchen islands, and hallways. Bold fabric piping outlines the profile, giving structure and graphic definition to the surface.

Designed by Ana Kraš, the HAY Ava Cone Pendant Light balances material innovation with visual clarity. Two diameters provide flexibility for solo drops, clusters, or linear arrangements, while the neutral colourway integrates easily into both natural and richly coloured schemes. A standard E27 bulb and HAY's Common Cord Set ensure straightforward installation and long-term maintenance.

**Please note, the cord set for this product is also available in White, Grey, Red, Green, Yellow, Lilac and Navy. [Contact us](#) for pricing and information.**

## PRODUCT SPECIFICATION

**Light Source:** 1 x Max 15W E27 LED (Excluded)

**IP Code:** 20

**Dimming:** Dimmable via mains phase dimming.

**Dimensions: 500:**  
Shade: Ø50cm  
Height: 18.5cm

**600:**  
Shade: Ø60cm  
Height: 23.5cm

Cable Length: 400cm

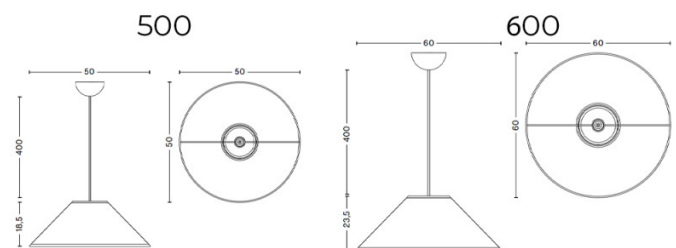



**For all sales and technical enquiries, please contact:**

+44 (0)114 263 4266

[info@davidvillagelighting.co.uk](mailto:info@davidvillagelighting.co.uk)

[www.davidvillagelighting.co.uk](http://www.davidvillagelighting.co.uk)