

FLOS

# Flos Coordinates LED Pendant

LA10315/P

SOURCE: <https://www.davidvillagelighting.co.uk/product/Flos-Coordinates-LED-Pendant/21074>



## PRODUCT DESCRIPTION

**Designer:** Michael Anastassiades

## Coordinates LED Pendant Light by Flos

Designed by Michael Anastassiades, the Coordinates pendant light is part of the [Coordinates collection](#), a new 2020 range released exclusively by Flos. The pendant is characterised by horizontal and vertical lines, being a geometric spectacle that produces a warm and inviting glow.

The Coordinates pendant has an integrated LED light source which is dimmable and is concealed by the silicone diffuser. The pendant light is available in 2 versions, S1 and S2, which both have their own unique aesthetic. You can use alone in a small space, or use multiple of both versions to create a grid configuration which will draw the eye in bigger spaces. Available in a beautiful anodised champagne or argent finish to add a touch of elegance to any interior.

## PRODUCT SPECIFICATION

<b>Light Source:</b>	<b>S1</b> - 37W, 2700K, 1920 lumens
<b>Source:</b>	<b>S2</b> - 55W, 2700K, 2960 lumens
<b>IP Code:</b>	20
<b>Dimming:</b>	Dimmable via 1-10V/Dali/Push to make dimming systems. Please consult your electrician, additional wiring may be required on site.
<b>Dimensions:</b>	<p><b>S1:</b> 78.2cm height 78.2cm width</p> <p><b>S2:</b> 92.2cm height 176.2cm width</p> <p>Ø15.2cm ceiling rose 250cm cable length</p>

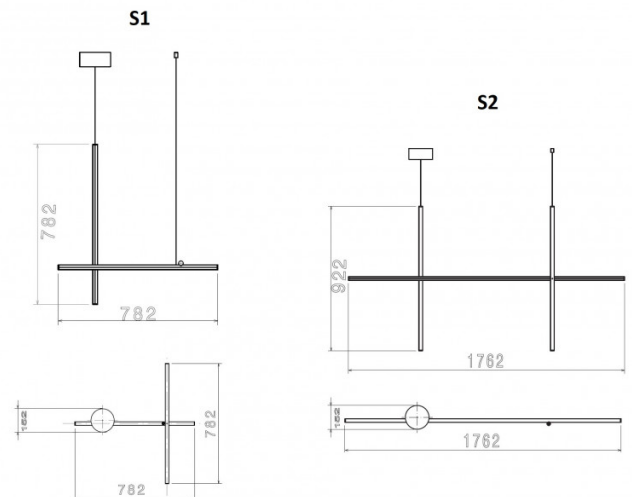

**For all sales and technical enquiries, please contact:**

+44 (0)114 263 4266

[info@davidvillagelighting.co.uk](mailto:info@davidvillagelighting.co.uk)

[www.davidvillagelighting.co.uk](http://www.davidvillagelighting.co.uk)